

## Contents

1. How to Put Your Heart Rate Monitor On
2. Functions and Modes of Polar A3
3. How to Start and Stop
4. Functions During Exercise
5. After Exercising
6. How to Recall File Stored in Memory
7. Settings
8. Target Heart Rate Zone
9. Resetting
10. Minimising Possible Risks in Exercising with Heart Rate Monitor
11. Technical Specifications
12. Limited Polar Warranty
13. Disclaimer

## 1. How to Put Your Heart Rate Monitor On

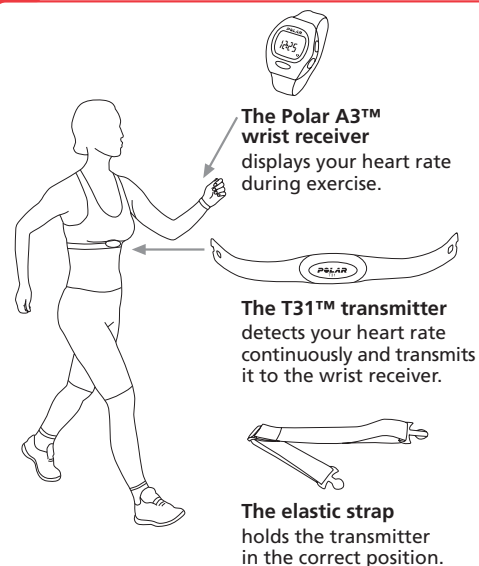

Keep the wrist receiver within 1 metre/3 feet of your transmitter. Check that you are not near other people with heart rate monitors or any source of electromagnetic disturbance.

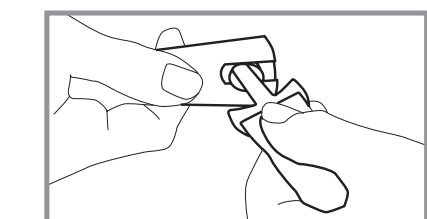

1. Attach the transmitter to the elastic strap.

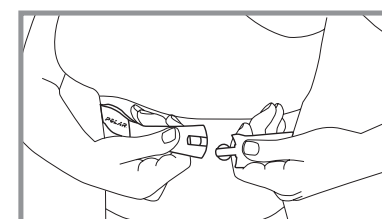

2. Adjust the strap length to fit snugly and comfortably. Secure the strap around your chest, just below the chest muscles, and buckle it.

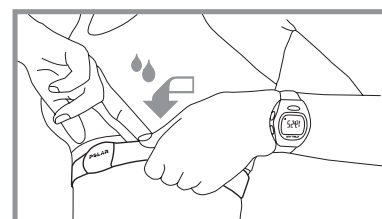

3. Lift the transmitter off your chest and moisten the two grooved electrode areas on the back.

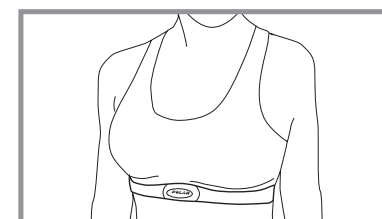

4. Check that the wet electrode areas are firmly against your skin and the Polar logo is in a central, upright position.

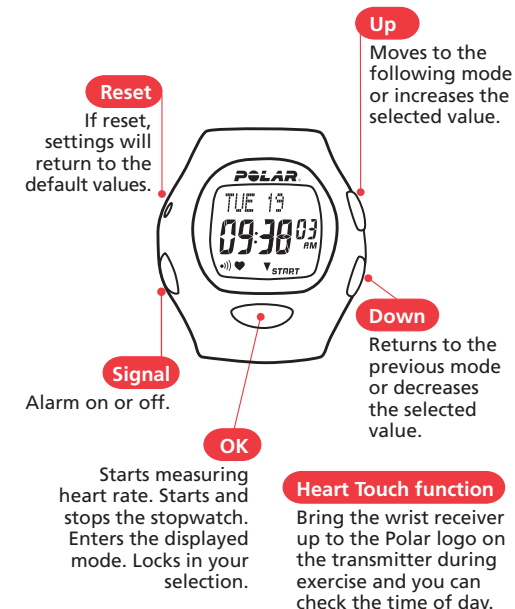

## 2. Functions and Modes of Polar A3

### How to operate the set buttons

- To move forward or back, use Up or Down button.
- To choose the value to begin adjusting, press OK. It will begin blinking.
- Press Up or Down button to adjust the value (The digits run faster if you press and hold the button).
- Wherever you are in the settings, you can return to the Time of day display by pressing and holding OK.

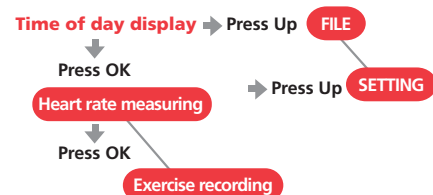

### Time of day display mode

- Starting point for all functions
- Shows date and time

Press and hold OK to return to the Time of day display, wherever you are in the Settings or File recalling cycle.

When the alarm is turned on, the symbol appears on the Time of day display. When the alarm comes on it will sound for one minute or you can turn it off by pressing any of the four buttons.

### Exercise recording mode

- In the Exercise mode you measure your heart rate and record your exercise information in a file
- You can view different information while the heart rate monitor is measuring heart rate

### File mode

- Shows the data recorded during the exercise

### Setting mode

- Set different values
  - 24h or 12h time mode
  - birthday
  - target heart rate limits
  - watch functions; alarm, time, date

## 3. How to Start and Stop

### How to Set up Your New Polar A3 Receiver

- Press any of the four buttons twice to activate the receiver. TIME is displayed. 12h is flashing.

- Once awakened, the receiver will guide you through the necessary settings. Scroll up or down to set the right values. Press OK to lock your selection.

Set the following:  
24h or 12h time mode  
Time of day  
Date  
Birthday

After setting your birthday, your target heart rate zone based on your age is automatically calculated.

After the settings are complete, the receiver automatically goes to the Time of day display.

**You can cancel the setting by pressing and holding OK, but you can not start measuring the heart rate before you have completed the settings.**

### How to Start

- In the Time of day display press OK. Your heart rate appears in a few seconds.
- Press OK again. The stopwatch starts running and you can start exercising. The exercise data will only be stored if you have turned the stopwatch on.



### How to Stop

- Press OK to stop the stopwatch. QUIT and paused stopwatch appear. Measurement is paused. Exercise is no longer recorded.



- Press Up or Down button to exit the Exercise mode. The receiver shows the Time of day display within 5 minutes if you forget to quit the heart rate measurement mode when you stopped the stopwatch and removed the transmitter from your chest.



## 4. Functions During Exercise

- Press Signal button to turn the zone alarm sound on or off.
- Check the time of day by bringing the wrist receiver up to the Polar logo on the transmitter.
- Scroll up to select what values you want to view in the upper row of the display during exercise.

- Heart rate in the target zone is displayed
  - a) as absolute heart rate
  - or
  - b) as a % of maximum heart rate
 according to your lower row selection.

- Fitness bullets  
For every 10 minutes in TZ, a appears.

- Scroll down to select what you want to view in the lower row of the display.

- Heart rate in beats per minute.

- Heart rate as a % of your maximum heart rate.

- Exercise time

- Time of day

- You can pause the stopwatch by pressing OK. Repressing OK will restart the stopwatch.

After restart you will see the heart rate in the lower row.

### 5. After Exercising

- Carefully wash the transmitter with a mild soap and water solution.
- Rinse it with pure water.
- Dry the transmitter carefully with a soft towel.
- Keep the wrist receiver clean and wipe off any moisture.
- Store the heart rate monitor in a clean and dry place. Dirt impairs the elasticity and functioning of the transmitter. Sweat and moisture can keep the electrodes wet and the transmitter activated, which shortens battery life.

### 6. How to Recall File Stored in Memory

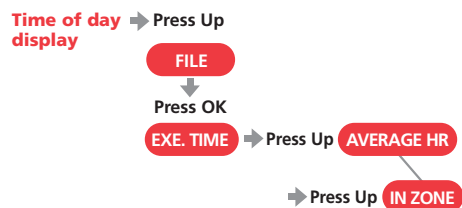

- While in the Time of day display mode press Up or Down until FILE is displayed.
- Press OK.
- Scroll up or down to recall the exercise information:  
**EXE. TIME** Total exercise time  
**AVERAGE HR** Average heart rate of the exercise  
**IN ZONE** Time spent in target zone

The training information is saved if the stopwatch has been on for more than one minute.

### 7. Settings

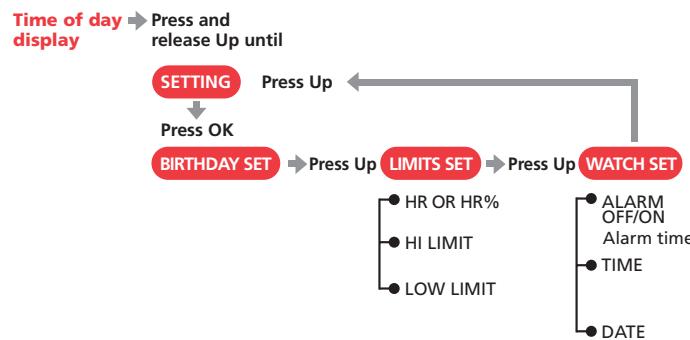

#### Settings step by step

#### 1. BIRTHDAY – setting your date of birth

- Start from the Time of day display
- Press Up or Down until display changes to SETTING
- Press OK, BIRTHDAY SET is displayed
- Press OK again

- Use Up or Down button to select the correct day
  - Press OK
  - Use Up or Down button to select the correct month
  - Press OK
  - Use Up or Down button to select the correct year
  - Press OK, BIRTHDAY SET is displayed
- 12h time display sequence: MONTH → DAY → YEAR

#### 2. LIMITS – setting target heart rate zone limits

- BIRTHDAY SET is displayed
- Press Up to advance, LIMITS SET is displayed
- Press OK
- With HR or HR% blinking use Up or Down to select whether you want to set the limits in beats per minute or as a percentage of a maximum heart rate
- Press OK to accept, HI LIMIT is displayed
- Use Up or Down button to determine the upper limit
- Press OK, LO LIMIT is displayed
- Use Up or Down button to determine the lower limit (the lower limit cannot be set above the upper limit)
- Press OK, LIMITS SET is displayed

#### 3. WATCH – time and day determination

- Alarm**
- Use Up button to advance from LIMITS display to WATCH SET, press OK (or in the Time of day display press and hold Signal button → WATCH SET)
  - ALARM ON or OFF blinks
  - Select alarm on or off
  - Press OK
  - If you set the alarm on: set the alarm time
  - In 12 h time mode, select AM/PM, press OK
  - Hours blink on the display, use Up or Down button to select the correct hour, press OK
  - Minutes blink on the display, use Up or Down button to select the correct minutes
  - Press OK

- Time**
- TIME is displayed
  - Press Up or Down button to select 24h or 12h time display
  - Press OK
  - In 12h time mode, select AM/PM with Up or Down button, press OK
  - TIME and blinking hours are displayed
  - Use Up or Down button to select correct time, press OK
  - TIME and blinking minutes are displayed
  - Use Up or Down button to select correct time, press OK

- Date**
- DAY and blinking day of month are displayed
  - Use Up or Down button to select the correct day
  - Press OK
  - MONTH and the blinking month are displayed
  - Use Up or Down button to select the correct month
  - Press OK
  - YEAR and the blinking number are displayed
  - Use Up or Down button to select the correct year
  - Press OK, press and hold OK to return to the Time of day display

12h time display sequence: MONTH → DAY → YEAR

### 8. Target Heart Rate Zone

Your target heart rate zone is a high and low range, which represents percentages of your current HR<sub>max</sub>.

When your heart beats at 50-60% of your HR<sub>max</sub>, you're in the **light intensity** zone. This kind of exercise is easy (a walk, for instance), but delivers some health benefits.

Push on to 60-70% of your HR<sub>max</sub> and you're in the **light to moderate intensity** zone. This is good for improving fitness, building endurance and recommended for weight loss.

At 70-85% of your HR<sub>max</sub>, you've moved into the **moderate to heavy intensity** zone. This is harder work, but good for strengthening your aerobic fitness.

You can set your target limits in beats per minute or as a percentage of your maximum heart rate. The percentage limits can not be set if you have not set your birthday.

When you set your birthday, the receiver automatically calculates the limits, which are 65-85% of your estimated maximum heart rate (220 – age). For an accurate measure of your maximum (HR<sub>max</sub>) and exercise heart rates, visit your doctor for an exercise stress test.

Reference: American College of Sports Medicine, ACSM's Guidelines for Exercise Testing and Prescription, Williams & Wilkins, 1995.

### 9. Resetting

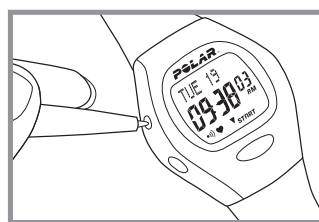

Resetting clears the settings which return to the default values.

If there are no reactions to any buttons, reset the receiver.

- Press RESET button with a pen tip. Display becomes full of digits.
- Press any of the four buttons once. If you don't press any button after resetting, within one minute the wrist receiver goes to the battery saving mode. Wake up by pressing any of the buttons twice.

### 10. Minimising Possible Risks in Exercising with Heart Rate Monitor

Exercise may include some risk, especially for those who have been sedentary. To minimise possible risks consider the following advice:

- Before beginning a regular exercise program consult your doctor**
- if you are over 40 years of age and have not been following a regular exercise program during the past 5 years
  - if you smoke
  - if you have high blood pressure
  - if you have high blood cholesterol
  - if you have any signs or symptoms of any disease
  - if you are recovering from a serious illness or a medical treatment e.g. surgery
  - if you use a pacemaker or another implanted electronic device.

Note that in addition to exercise intensity, heart, circulation (particularly high blood pressure), asthma and other breathing medications as well as some energy drinks, alcohol and nicotine, can affect the heart rate.

**It is important to be sensitive to your body's reactions during exercise.** If you feel unexpected pain or excessive fatigue when exercising, it is recommended to stop the exercise or continue at a lighter intensity.

**If you are allergic to any substance that comes into contact with the skin,** check the Polar heart rate monitor materials from the 'Technical specifications' chapter. It is recommended that you wear the transmitter against your bare skin to ensure flawless operation. However, if you wish to wear the transmitter over a shirt, moisten the shirt well under the electrodes.

**Notice to persons with pacemakers, defibrillator or other implanted electronic device.** Persons who have a pacemaker use the Polar heart rate monitor at their own risk. Before starting use, we always recommend an exercise test under doctor's supervision. The test is to ensure the safety and reliability of the simultaneous use of the pacemaker and the heart rate monitor.

### 11. Technical Specifications

All Polar heart rate monitors are designed to indicate the level of physiological strain and intensity in sports and exercise. No other use is intended or implied. Heart rate is displayed as number of heartbeats per minute (bpm).

**Polar Transmitter**  
 Battery type: Built-in Lithium Cell  
 Battery life: Average 2500 hours of use  
 Operating temperature: -10 °C to +50 °C / 14 °F to 122 °F  
 Material: Polyurethane

**Elastic Strap**  
 Buckle material: Polyurethane  
 Fabric material: Nylon, polyester and natural rubber including a small amount of latex

**Wrist Receiver**  
 Battery type: CR 2032  
 Battery life: Average 1 year (2h/day, 7 days/week)  
 Operating temperature: -10 °C to +50 °C / 14 °F to 122 °F  
 Water resistance: to 30 metres/100 feet, OK button can be pressed in water

Wrist strap: Polyurethane  
 Wrist strap buckle: Polyoxymethylene  
 Back cover: Stainless steel complying with the EU Directive 94/27/EU and its amendment 1999/C 205/05 on the release of nickel from products intended to come into direct and prolonged contact with the skin.

Accuracy of heart rate measurement: ± 1% or ± 1 bpm, whichever larger, definition applies to steady state conditions

**Default settings**

Time of day	12h
Alarm clock	OFF
Zone alarm	On
Age	0
Upper Limit	160
Lower Limit	80

**Limit values**

Chronometer	23 h 59 min 59 s
Heart rate limits	30 – 240 bpm
Total time	99 h 59 min 59 s
Birth day year range	1900 – 1999

### 12. Limited Polar Warranty

- Polar Electro Oy warrants to the original consumer/ purchaser of this heart rate monitor that the product will be free from defects in material or workmanship for one year from the date of purchase. **Please keep the receipt which is your proof of purchase!**
- Warranty does not cover receiver battery, damage due to misuse, abuse, accidents or non-compliance with the precautions; improper maintenance, commercial use, cracked or broken cases.
- Warranty does not cover damage or consequential damage caused by service not authorised by Polar Electro Oy.
- During the warranty period the product will be either repaired or replaced at an authorised service center free of charge.
- This warranty does not affect the consumer's statutory rights under applicable national or state laws in force, or the consumer's rights against the dealer arising from their sales/purchase contract.

This CE marking shows compliance of this product with Directive 93/42/EEC.

Copyright © 2001 Polar Electro Oy, 90440 Kempele, Finland  
 All rights reserved. No part of this manual may be used or reproduced in any form or by any means without prior written permission of Polar Electro Oy.  
 Polar logotype is a registered trademark and Polar A3 is a trademark of Polar Electro Oy.

This product is protected by one or several of the following patents:  
 FI 88223, DE 4215549, FR 92.06120, GB 2257523, HK 113/1996, SG 9591671-4, US 5491474, FI 88972, FR 92.09150, GB 2258587, HK 306/1996, SG 9592117-7, US 5486818, FI 96380, US 5611346, EP 665947, DE 69414362, FI 68734, DE 3439238, GB 2149514, HK 812/1989, US 4625733, FI 100924, DE 3439238, GB 2149514, FI 4069, DE 29910633, FI 104463.  
 Other patents pending.

### 13. Disclaimer

- The material in this manual is for informational purposes only. The products it describes are subject to change without prior notice, due to the manufacturer's continuous development program.
- Polar Electro Oy makes no representations or warranties with respect to this manual or with respect to the products described herein. Polar Electro Oy shall not be liable for any damages, direct or incidental, consequential or special, arising out of, or related to the use of this material or the products described herein.

Manufactured by:

Polar Electro Oy  
 Professorintie 5  
 90440 KEMPELE  
 Finland  
 Tel. +358-8-520 2100  
 Fax +358-8-520 2300

[www.polar.fi](http://www.polar.fi)